

The T150 hedge trimmer is perfectly adapted to excavators from 1,5t/3300lbs up to 8t/17600lbs operating weight and skid-steer loaders. Thanks to the robust attachment, the hedges and bushes can be cut faster, more precisely and efficiently.



- ▷ High performance, robust design and low maintenance.
- ▷ Fast change from left to right.
- ▷ Cuts branches up to 40mm/1.5in.
- ▷ Exchangeable teeth.
- ▷ Ready for work delivery - including hydraulic hoses and quick couplings.
- ▷ Optional: 1m/39.3in extension to a full length of 2,5m/98.4in.
- ▷ Mounting options: double pin suspension for excavator or adapter frame for skid-steer loader.
- ▷ Three different motors available.

Hedge Trimmer T150

Type	Operating weight (t/lbs)	Cutting length (mm/in)	Weight (kg/lbs)	Up to diameter (mm/in)	Motor (cc)	Flow* (l/min/GPM)	Operating pressure max. (bar/psi)
T150-50	1,5-2,5 / 3300-5500	1500 / 59	86 / 189.2	up to 25 / 1.0	50	30-48 / 7.5-12.7	150-220 / 2160-3190
T150-80	2,5-4,5 / 5500-9900	1500 / 59	87 / 191.4	up to 40 / 1.5	80	40-68 / 10.5-18	150-220 / 2160-3190
T150-100	4,5-8 / 9900-17600	1500 / 59	88 / 193.6	up to 40 / 1.5	100	50-71 / 13.2-18.7	150-220 / 2160-3190

Package consists of: hedge trimmer, hydraulic hoses and quick couplings

* when using a T150 Ext extension the flow must be 45 l/min / 11.9 GPM minimum

Accessories

Type	Description
T150 Ext	extension, cutting length: 1000mm/39.3in, total length: 1058mm/41.6in, weight: 26kg/57.2lbs
KSW01-T150	adapter for system L-Lock KMS01L/KHS01L for T150 - up to 2t/4400lbs
KSW03-T150	adapter for system L-Lock KMS03L/KHS03L for T150 - up to 6t/13200lbs
KSW08-T150	adapter for system L-Lock KMS08L/KHS08L for T150 - up to 12t/26400lbs

Adapter for excavator mounting or directly with **NOX** Tiltrotator available on request

Pictures



extension

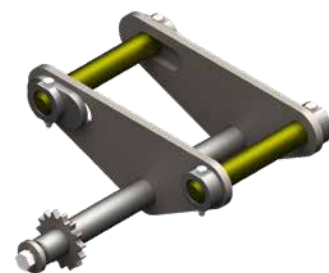

adapter for use on excavator