

D 40



All pictures shown are for illustrative purposes only and may contain optional equipment.

DUMPER SYSTEM

The D 40 is an extremely versatile vehicle for transporting construction site material, suitable for areas with limited room for manoeuvre, such as alleyways, small construction sites or tunnels, as well as on rough and off-road terrain. The articulated chassis and front oscillating axle, the tested reversible driver's seat, the spacious (ROPS-FOPS) cab supplied as standard, and the low centre of gravity, all together, enhance visibility and manoeuvrability and, above all, make the FIORI D 40 the safest 4.0 tonne dumper on the market. Featuring a strictly hydrostatic transmission, with 180° dump body rotation and the ability to unload on three sides, this dumper is not only the smallest machine in its class, but also excels in terms of traction and manoeuvrability on harsh terrain. Any area can be reached or travelled over, moving in both directions with the utmost safety thanks to the pioneering reversible driver's seat.

FIORI

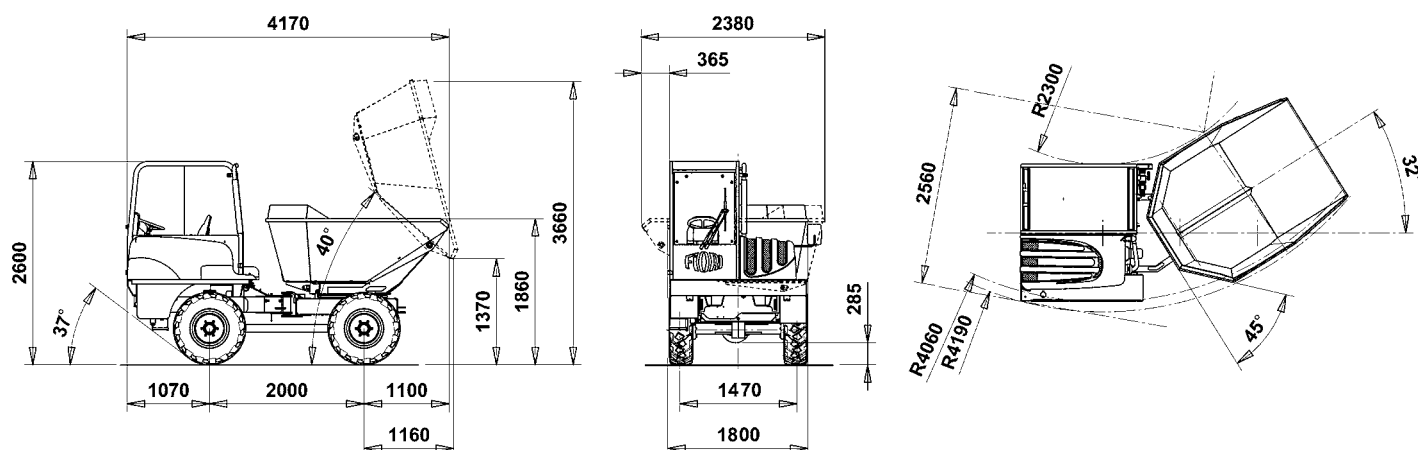

DIESEL ENGINE	Stage IIIA / Tier 3	Tier 4 Final EPA	Stage V
Model :	YANMAR 4TNV88	KOHLER series KDI 1903 TCR	KOHLER series KDI 1903 TCR
Type :	Aspirated	Turbo Intercooler	Turbo Intercooler
Total displacement, no Cylinders:	2190cc - 4 in line	1861cc - 3 in line	1861cc - 3 in line
Injection :	Direct with mechanical control	Electronic control with Common Rail	Electronic control with Common Rail
Aftertreatment sys. :	-	EGR + DOC	EGR + DOC + DPF
Cooling :	air water, dry air filter	air water, dry air filter	air water, dry air filter
Maximum power :	36,9 kW (49 Hp)	42 kW (56 Hp)	42 kW (56 Hp)
Adj. power :	32 kW (44 Hp) a 2600 rpm	42 kW (2600 rpm)	42 kW (2600 rpm)
Maximum torque :	139 Nm a 1200 rpm	225 Nm a 1500 rpm	225 Nm a 1500 rpm
Alternator :	12V - 40 A	12V - 55 A	12V - 55 A

ELECTRIC SYSTEM

Battery:

Stage III A 12 V - 80 Ah (560 A)

Tier 4 final 12 V - 70 Ah (720 A)

Stage V 12 V - 70 Ah (720 A)

Road light system, rear working lights, optional/standard depending on engine type.

4X4 FOUR-WHEEL DRIVE

Hydrostatic "automotive" transmission with variable displacement pump and variable displacement hydraulic motor with electro-hydraulic control, and reverse gear control on the steering wheel. Mechanical gearbox for "working speed" and "road transfer" speed, with mechanical control.

SPEED

4 forward gears 4 reverse gears

I° 0 - 5.0 Km/h 0 - 5.0 Km/h

II° 0 - 7.2 Km/h 0 - 5.0 Km/h

III° 0 - 14.2 Km/h 0 - 14.2 Km/h

IV° 0 - 20.2 Km/h 0 - 14.2 Km/h

Traction / weight ratio 55%

AXLES AND WHEELS

Front load-bearing, oscillating ($\pm 7^\circ$) with planetary reduction gears on the wheel hubs.

Rear load-bearing with planetary reduction gears on the wheel hubs and directly flanged gearbox.

Tyres 12.0/75-18 12PR

BRAKES

Internal oil-bath disc service and emergency brakes acting on the 4 wheels, activation with pump on independent dual circuit.

Drum parking brake on the front axle with lever control.

STEERING

Assisted by means power steering acting on 2 half-frames by means of two opposed jacks.

EQUIPMENT HYDRAULIC SYSTEM

Gear pump

Max. flow rate: 35 litres/min.

Maximum pressure: 170 bar

2 - elements distributor.

Aluminium heat exchanger for hydraulic oil cooling.

Pressurised closed-circuit intake with oil filter replaceable from the outside.

DUMP BODY

Dump body tilting by means of 1 double-acting jack. Orientation over 180° for trilateral unloading by means of two opposing jacks.

Struck capacity 2000 litres

SAE heaped capacity 2700 litres

CAB

Open cab designed according to ROPS & FOPS Lev. I criteria, windows on three sides. 180° pivoting driving post. Anatomic seat with flexible suspension and height adjustment, seat belts.

Driving and equipment controls with ergonomic arrangement.

LCD TV display with camera for rear visibility.

SERVICE REFILL CAPACITIES

Fuel tank: 46 litres

Total hydraulic system capacity: 67 litres

Engine oil: 7 kg

WEIGHTS

Operating weight: 3400 kg

Max gross weight: 7400 kg

load-carrying capacity: 4000 kg